

ChargeBottle® P2

Lightweight powder transfer containers

Suitable for pharma, chemical and food use:

- FDA compliant materials
- Good chemical compatibility
- Pressure rated for robust and varied application

Maximise product flow and yield:

- Joint free construction
- Optimum cone shape
- FDA compliant anti-static additive
- Optional wet/dry flush port

Suitable for aseptic processing:

- Gamma stable

Applications:

- Bulk powders
- Granulates
- API
- Intermediates
- Buffer media
- Components (e.g. vial closures)

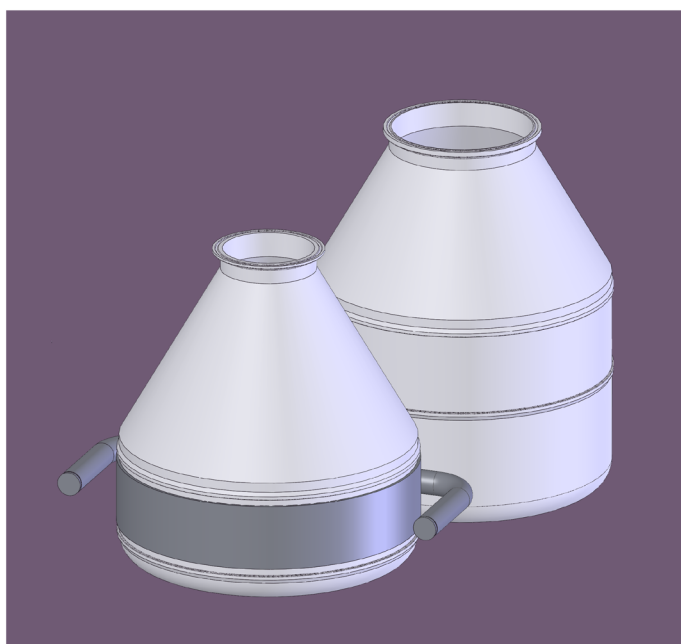

Dimensions

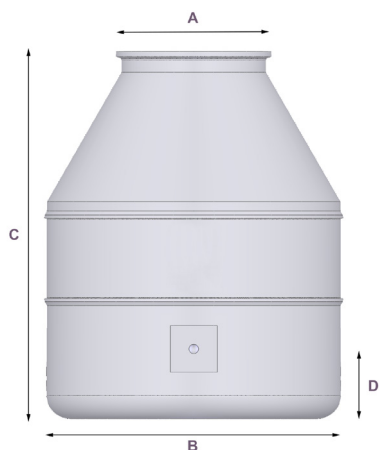

| | 10L | | 20L | |
|------------------------------------|------------|------------|------------|------------|
| Connection (A) mm | DN100 (4") | DN150 (6") | DN100 (4") | DN150 (6") |
| Outside diameter (B) mm | 320 | 320 | 320 | 320 |
| Total height (C) mm | 341 | 295 | 440 | 394 |
| Port position height (D) mm | 75 | 73 | 75 | 75 |

Range & Specifications

| | 10L | | 20L | |
|-----------------------------|---|--------------------------|-------------------------|-------------------------|
| Connection Size | DN100 (4") | DN150 (6") | DN100 (4") | DN150 (6") |
| Volume (L) (nominal) | 10L (15.6L effective) | 10L (15.1L effective) | 20L (22.8 effective) | 20L (22.3 effective) |
| Weight (approximate) | 1.5kg | 1.5kg | 2kg | 1.9kg |
| Connection Type | Tri-Clamp | | | |
| | 100mm BS4825 standard (compatible with ASME BPE, ISO 2852, DIN 32676 Series A&C and IDF) | | | |
| | 150mm BS4825 non-standard equivalent (compatible with ASME BPE, DIN 32676 Series C) | | | |
| Materials | Marlex HHM 5502BN High Density Polyethylene (HDPE) | | | |
| | Excellent stiffness and durability | | | |
| | Good chemical compatibility | | | |
| | Gamma stable | | | |
| Compliance | FDA 21 CFR 177.1520(c) 3.2a, use conditions B through H per 21 CFR 176.170(c) | | | |
| | USP Class VI | | | |
| Pressure Rating | 500mBarG (7.2 psi) | | | |
| Purge/Vent Port | 1" BS4825 tri-clamp port - available as an additional option | | | |
| Handle Clamp | Stainless steel clamp with over centre latch and two (2) hand grips - available as an additional option (sold separately) | | | |

Accessories

| | |
|-----------------------------|---|
| Modular handle clamp | Ergonomic handle grips to assist safer manual handling |
| Vibratory collar | Modular attachment pneumatically operated to assist powder flow |
| Bottle hoist | Fixed mobile or pneumatic hoists for automatic raise and lower docking |
| Bottle wash station | Manual or automatic washing of containers without breaking a containment seal |
| Tri-Clamps | Stainless steel or plastic (Nylon) |
| Tri-Clamp gaskets | EPDM, PTFE |



Europe, Middle East, Africa & Asia

ChargePoint Technology Ltd
80 Venture Point West, Evans Road
Liverpool, L24 9PB
United Kingdom
+44 151 728 4500
sales@thechargepoint.com

Americas

ChargePoint Technology Inc.
120 North Main Street, Suite 11
Forked River, NJ 08731
United States
+1 609 549 6165
USAsales@thechargepoint.com

Find your local representative online:
www.thechargepoint.com

